



mazda

Mazda CX-9

Towbar Kit Part No: TC11ACTB

Harness Kit Part No: TC11ACTWH

Towbar Fitting Time: 45 minutes

Harness Fitting Time: 20 minutes

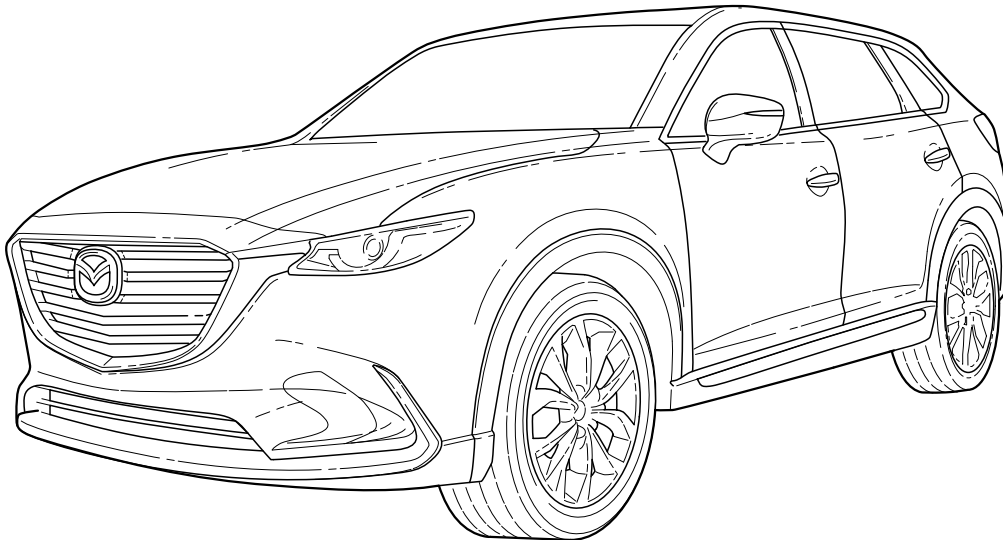

Trailer Wiring Harness Fitting Instructions



– General Notes

- Read through the fitting instructions before installation of accessory.
- Always install the Mazda Trailer Wiring Harness following the workshop manual and the fitting instructions provided. Failure to do so may cause damage to the vehicle or the accessory.
- Ensure all recyclable components and packaging are discarded and recycled following local recycling regulations.
- It is always recommended that the Mazda Trailer Wiring Harness is fitted by a qualified Mazda Technician.
- Safely store and protect any removed vehicle components.

– Safety Notes

- Check that all work practices comply with safety standards.
- Please wear appropriate clothing and use safety equipment.



– Fitting Time



20 minutes

– Parts Supplied

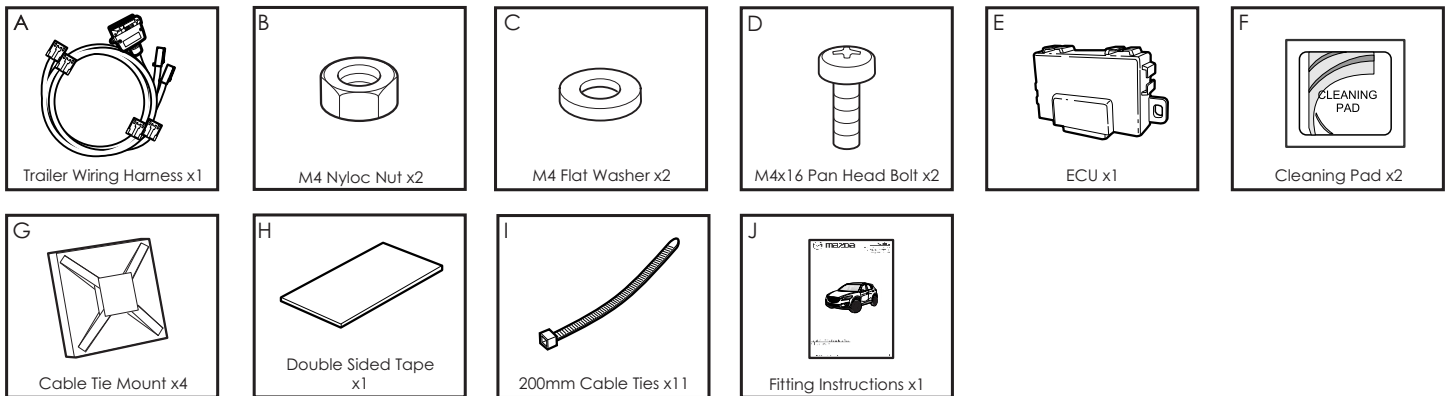

– Tools and Materials Required





– Step 1

Important



Always refer to the vehicle's Workshop Manual when removing vehicle components.

This Trailer Wiring Harness kit is designed to be fitted together with the Towbar kit Part No. TC11ACTB supplied separately. Steps 1-13 will be completed as part of the Towbar installation.

- Raise the tailgate.
- In the engine bay, disconnect the negative battery terminal.
- In the luggage compartment, fold the rear seats forwards (1).
- Remove the floor cover carpets (2).

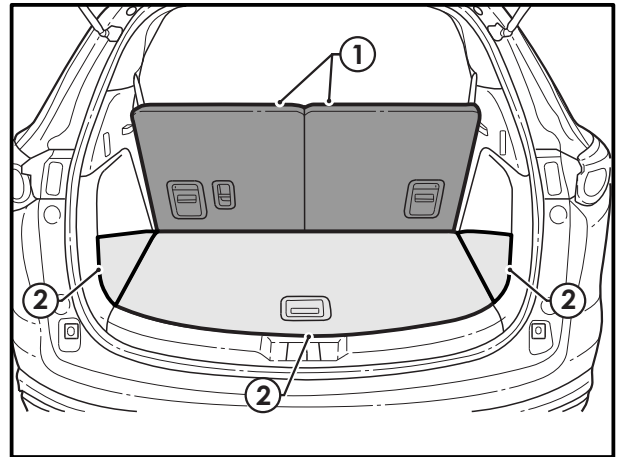

– Step 2

- Remove both the LHS and RHS plastic trays (1).

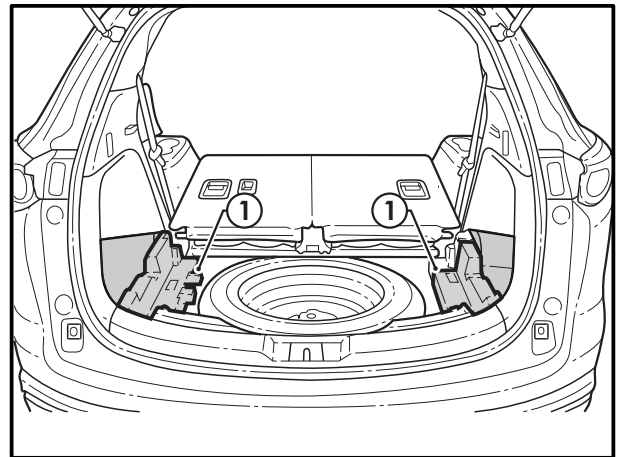

– Step 3

- Remove the rear luggage compartment trim (1) by pulling in an upwards direction.

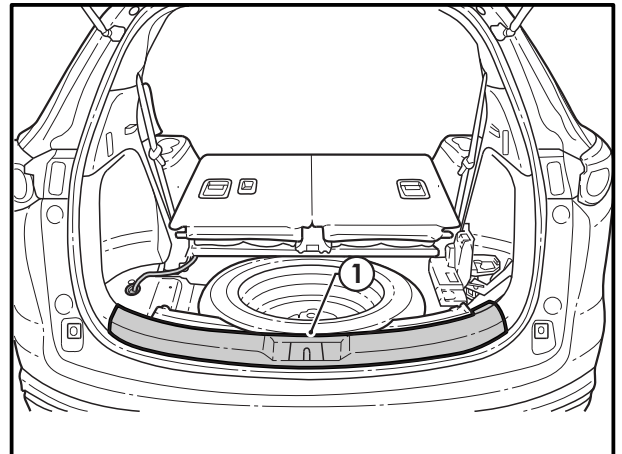



— Step 4

- Remove the vehicle jack (1) and the plastic trim (2).

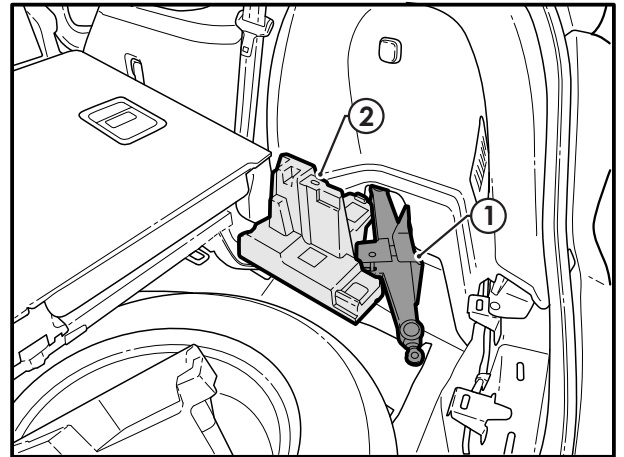

— Step 5

- Remove both plastic screw covers (1) and remove the two phillips head screws (2).

Repeat for the LHS.

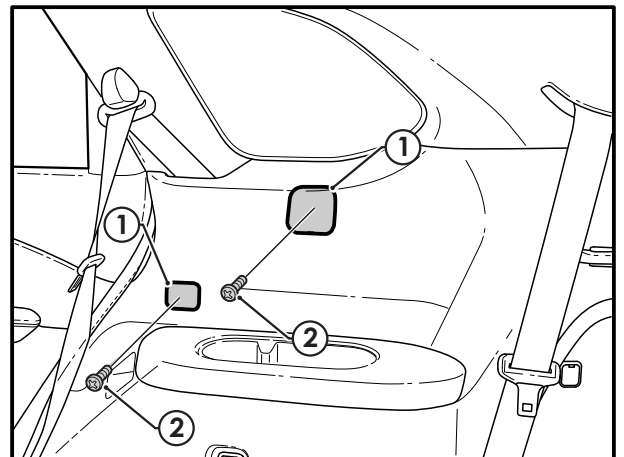

— Step 6

- On the RHS luggage compartment trim (1) remove the clip (2).
- Remove the RHS cargo hooks (3) by first removing the 10mm bolts (4).
- Dislodge the RHS luggage compartment trim (1).

Repeat for the LHS.

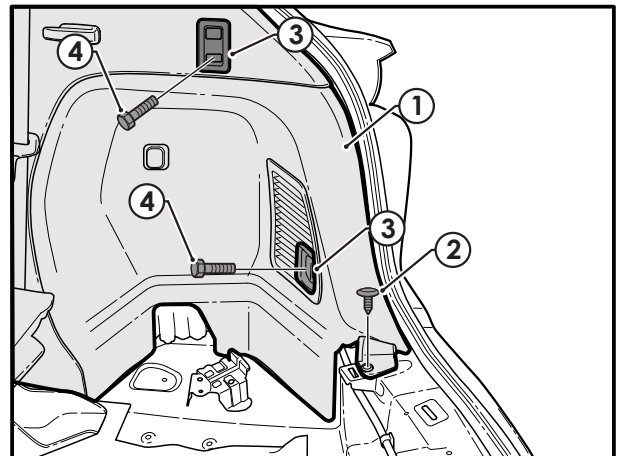



– Step 7

- Remove the six plastic screw covers (1) and remove the eight phillips head screws.
- Disconnect the taillamp connectors and remove the taillamps (2).

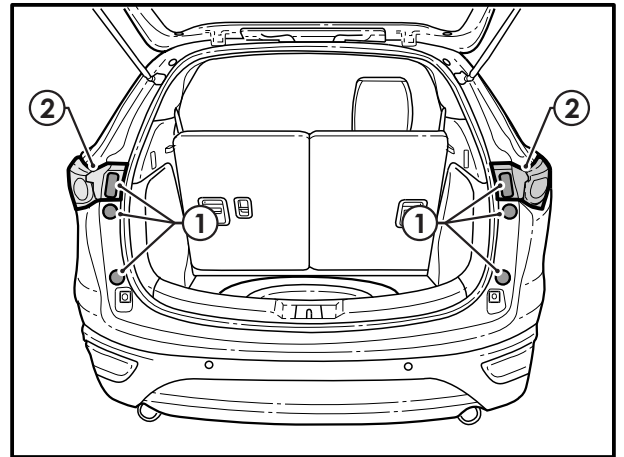

– Step 8

- Inside the LHS rear wheel arch, remove the clip (1).

Repeat for RHS.

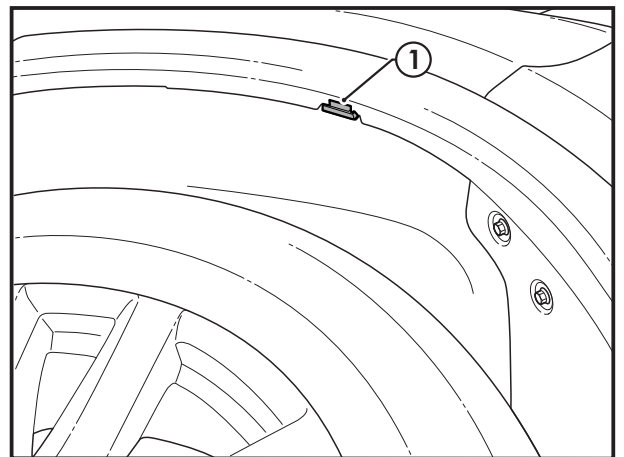

– Step 9

- Remove the scrivet (1).
- Remove the LHS plastic wheel arch trim (2) by carefully dislodging the clips.

Important



Ensure the plastic wheel arch trim doesn't twist or bend.

Repeat for the RHS.

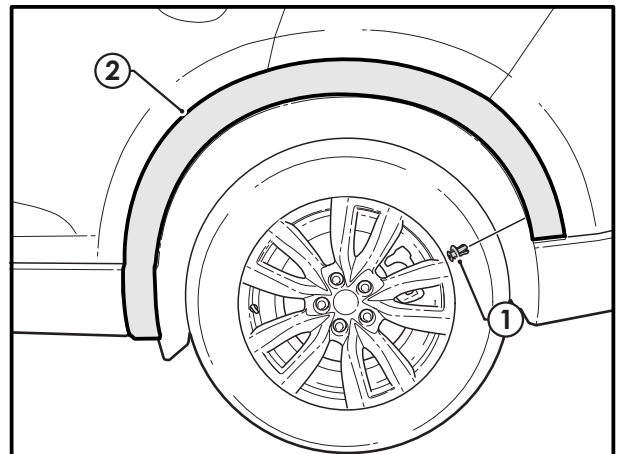



– Step 10

- At the LHS rear wheel arch, remove the four clips **(1)** and the phillips head screw **(2)**.

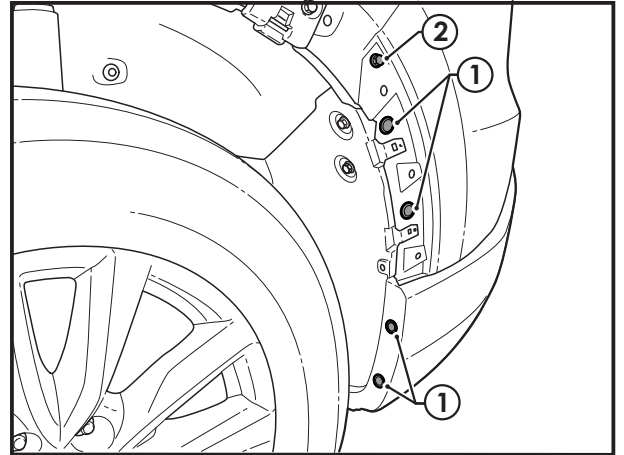

– Step 11

- Remove the two fasteners **(1)** and the scrivet **(2)** located under the rear bumper fascia, behind the LHS rear wheel.

Repeat for the RHS.

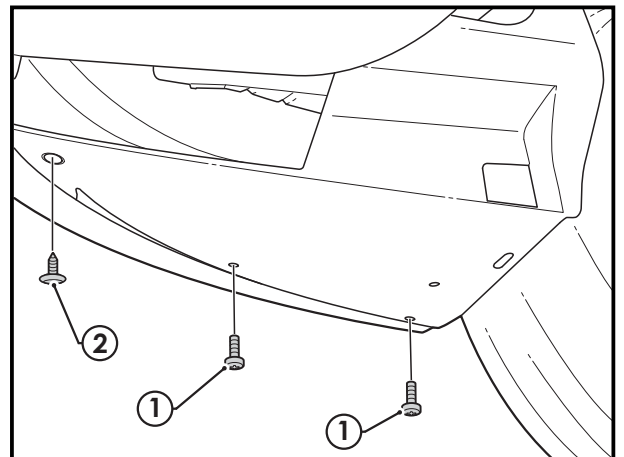

– Step 12

- From underneath the rear bumper fascia, remove the two clips **(1)**.

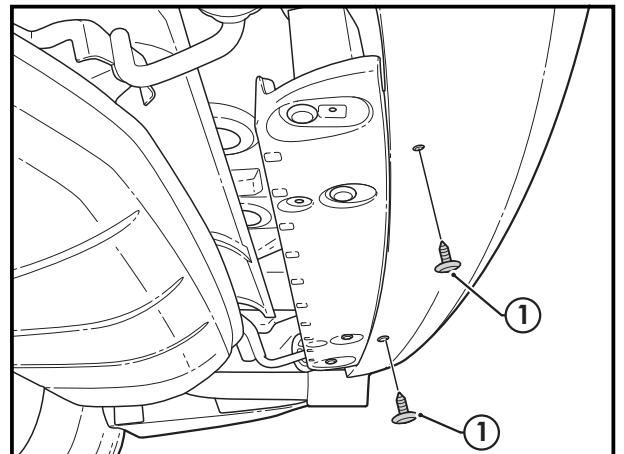



– Step 13

- Dislodge the rear bumper fascia (1) and disconnect the 10-way connector.
- Remove the rear bumper fascia (1).

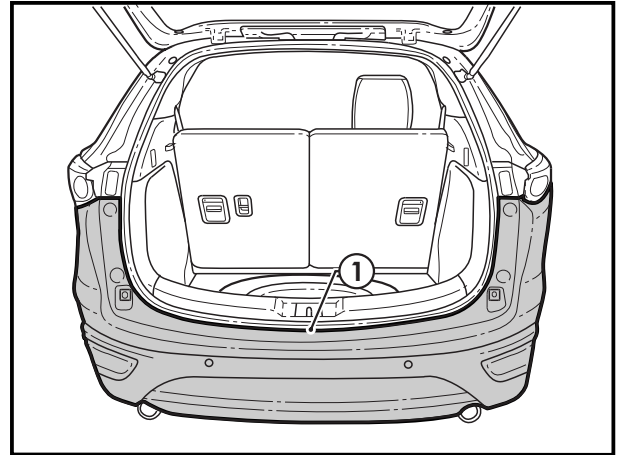

– Step 14

- Secure the Trailer Socket (1) to the trailer socket bracket (2) using the supplied M4 Pan Head Bolts (3), M4 Flat Washers (4) & M4 Nyloc Nuts (5).

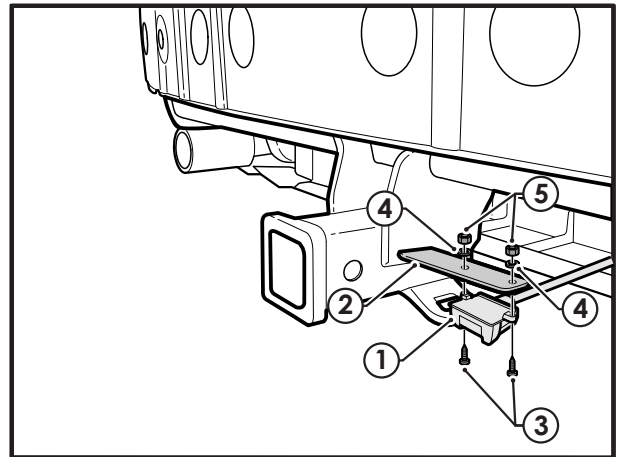

– Step 15

- Route the Trailer Wiring Harness (1) from the trailer socket along the top of the towbar assembly (2) towards the RHS rear quarter panel.
- Using the supplied Cleaning Pad, clean the area (3) of the towbar assembly where the Cable Tie Mounts (4) will be mounted.

Important



Allow the area cleaned to dry before proceeding.

- Adhere the Cable Tie Mounts (4) to the previously cleaned areas.
- Using the supplied Cable Ties, secure the Trailer Wiring Harness (1) to the Cable Tie Mounts (4).
- In the RHS rear quarter of the luggage compartment, remove the vehicle blanking grommet and route the Trailer Wiring Harness through the vehicle grommet hole.
- Ensure the Trailer Wiring Harness grommet (5) is seated correctly and makes a good seal.

Important



Ensure the Trailer Wiring Harness grommet is seated correctly in the rear quarter panel grommet hole to prevent any water ingress.

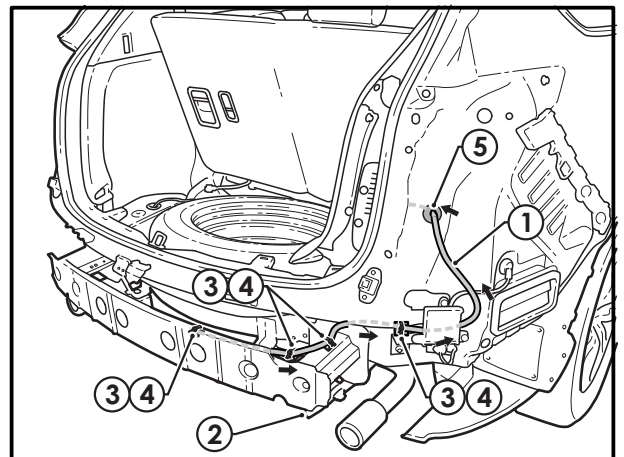



– Step 16

- Connect the Trailer Wiring Harness ECU 12-way connector (1) to the ECU (2).
- Using the supplied Cleaning Pad (3), clean the back of the ECU (2) and the area (4) where the ECU (2) will be mounted.

Important



Allow the area cleaned to dry before proceeding.

- Adhere the supplied Double Sided Tape (5) onto the ECU (2).
- Secure the ECU (2) to the previously cleaned location.

Important



Always ensure the ECU is mounted with the 12-way connector facing downwards to avoid any chance of water ingress or condensation.

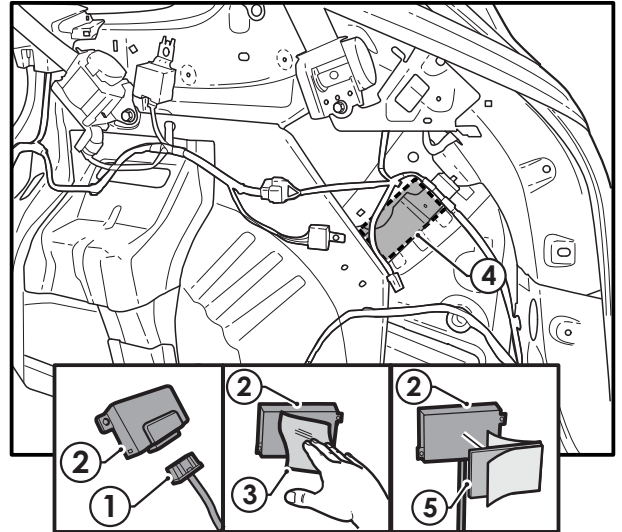

– Step 17

- Connect the 8-way connector (1) from the Trailer Wiring Harness (2) to the vehicle 8-way connector (3).

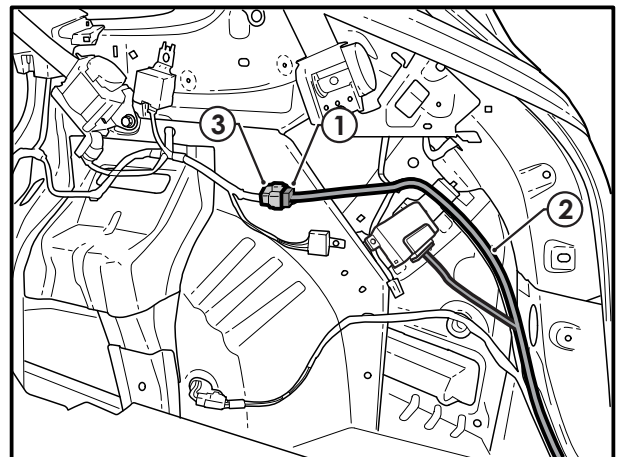

– Step 18

If the vehicle is NOT fitted with an Electric Brake System, proceed to Step 19.

If the vehicle is fitted or being fitted with an Electric Brake System, continue:

- Connect the 2-way connector (1) from the Trailer Wiring Harness (2) to the 2-way connector (3) on the Electric Brake Harness (4).

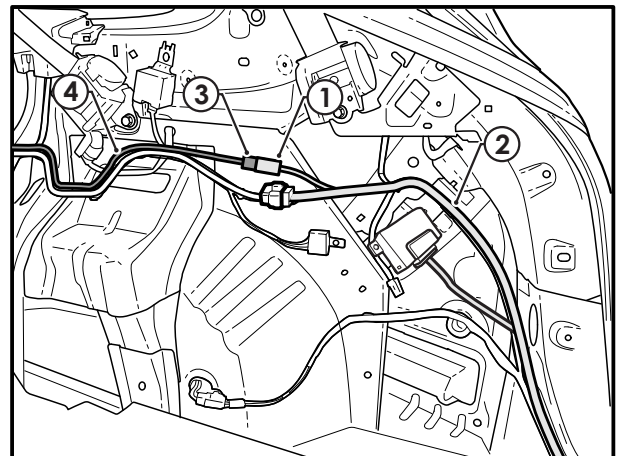



– Step 19

- Reconnect the negative battery terminal.
- Test the operation of the Trailer Wiring Harness using trailer wiring test lights or a multimeter to ensure correct operation. Ensure the RPA system is disabled when the trailer socket cap is opened.
- Dispose of any parts not used from the fitment.

Important

Secure all harnesses to the vehicle using the supplied cable ties. Refit all removed parts and secure all fasteners to Service Manual torque specifications.

Important

Reprogram all radio stations and clock settings by referring to the vehicle's Workshop Manual.



Please place the Installation Manual in the glove box after the installation is completed.

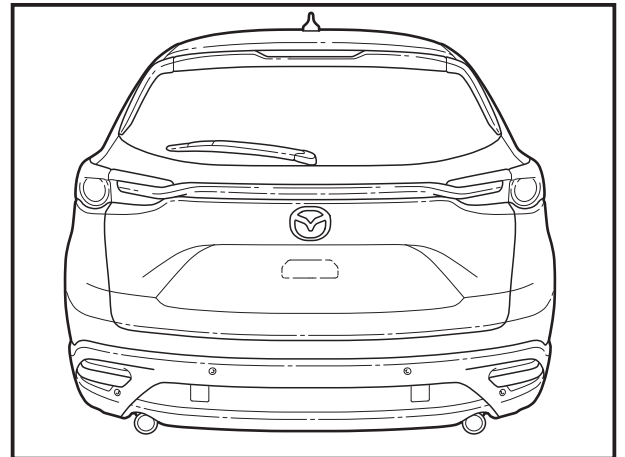

E.& O.E. This document is copyright and must not be used except as permitted below or under the Copyright Act 1968. You may reproduce and publish this document in whole or in part for your or your organisation's own.

Personal or internal compliance, educational or non-commercial purposes. You must not alter or amend this document in any way. You must not reproduce or publish this document for commercial gain without the prior written consent of the copyright owner.