

## OUTER MIRROR GLASS INSTALLATION

### Note

- Installation of the outer mirror glass can be facilitated by heating the outer mirror glass holder to approx. 50 °C {90 °F} to 60 °C {108 °F} using a heat gun.

### Caution

- Be careful not to overheat the outer mirror, as temperatures higher than 60 °C {108 °F} could deform it.

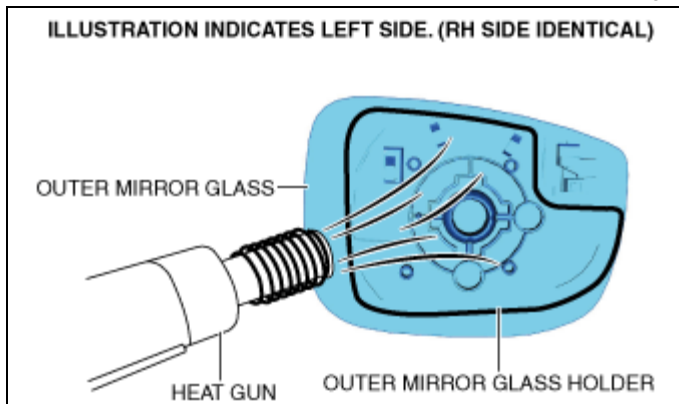

ac5uuw00006050

1. To facilitate installation of the outer mirror glass, orient the outer mirror in the direction of the arrow shown in the figure.

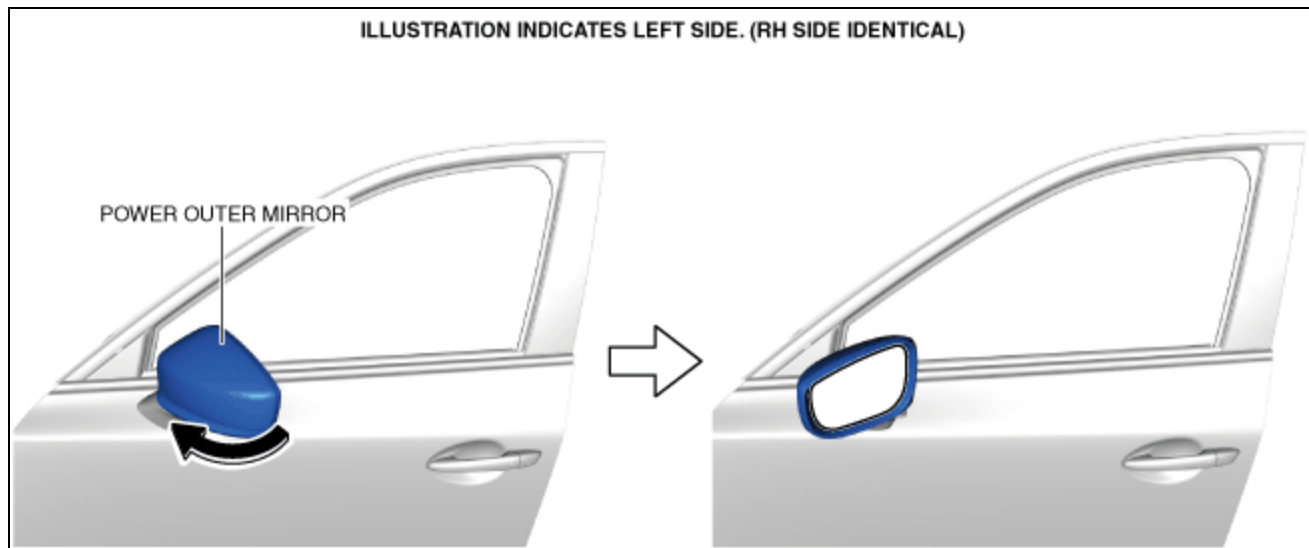

ac5uuw00006051

2. To prevent scratches or damage, apply protective tape to the positions shown in the figure.

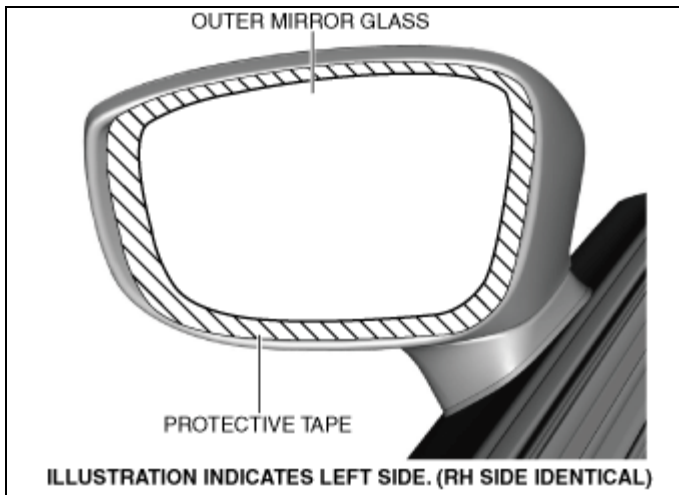

ac5uuw00006052

3. Connect the heated outer mirror connectors. (with heated outer mirror)

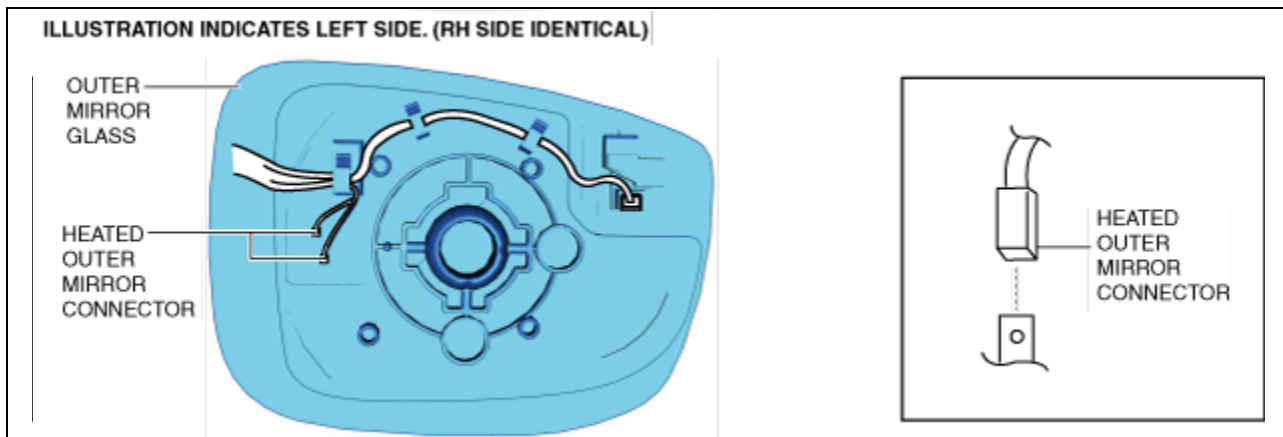

ac5wzw00012969

4. Connect the blind spot monitoring (BSM) indicator light connector. (with blind spot monitoring (BSM) system)

**Caution**

- Lightly pull the blind spot monitoring (BSM) indicator light connector to verify that it cannot be pulled out of the blind spot monitoring (BSM) indicator light housing. If the connection is poor, insert a tape-wrapped flathead screwdriver into position A shown in the figure and engage the connector.

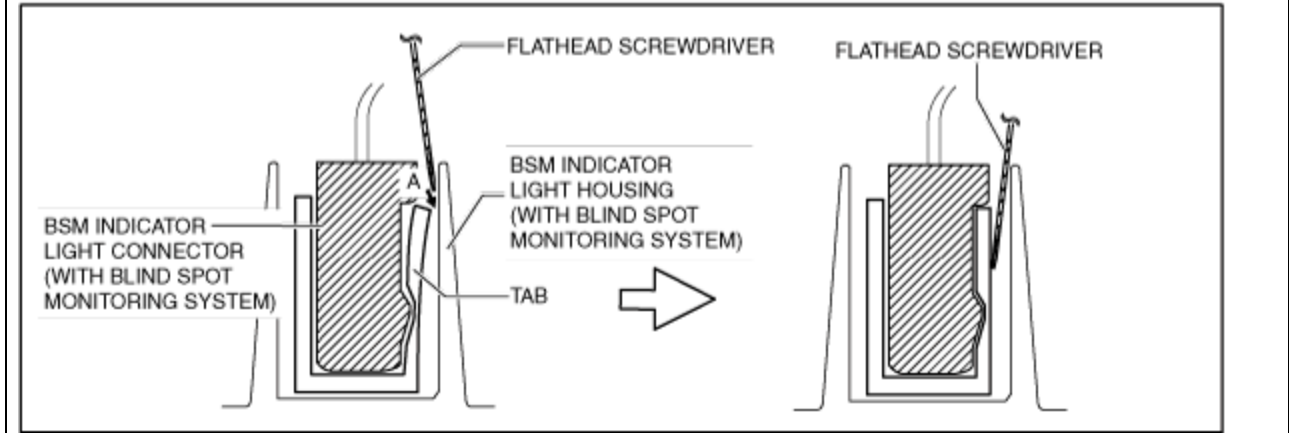
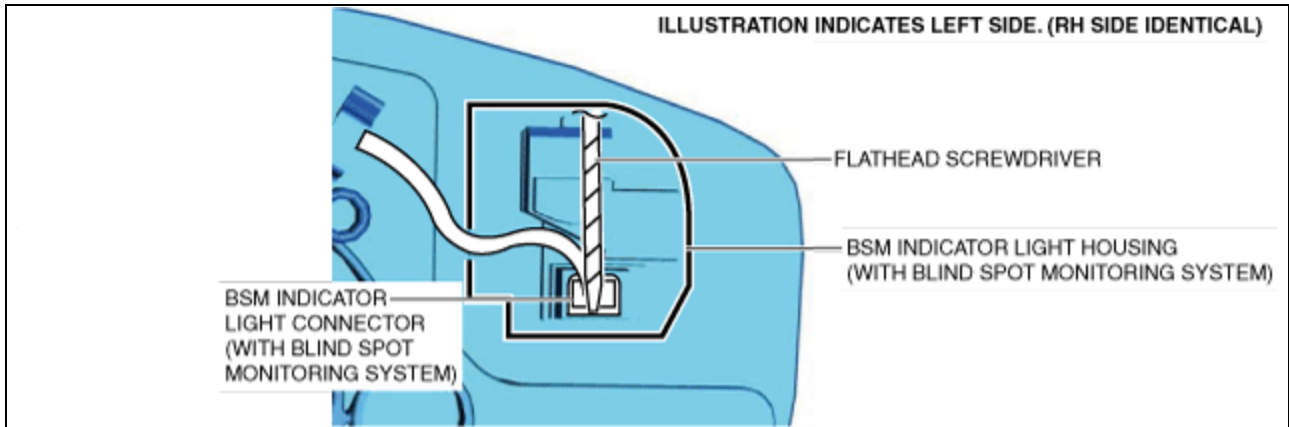

ac5uuw00006054

5. Press in outer mirror pins B and C in the direction of the arrows shown in the figure.

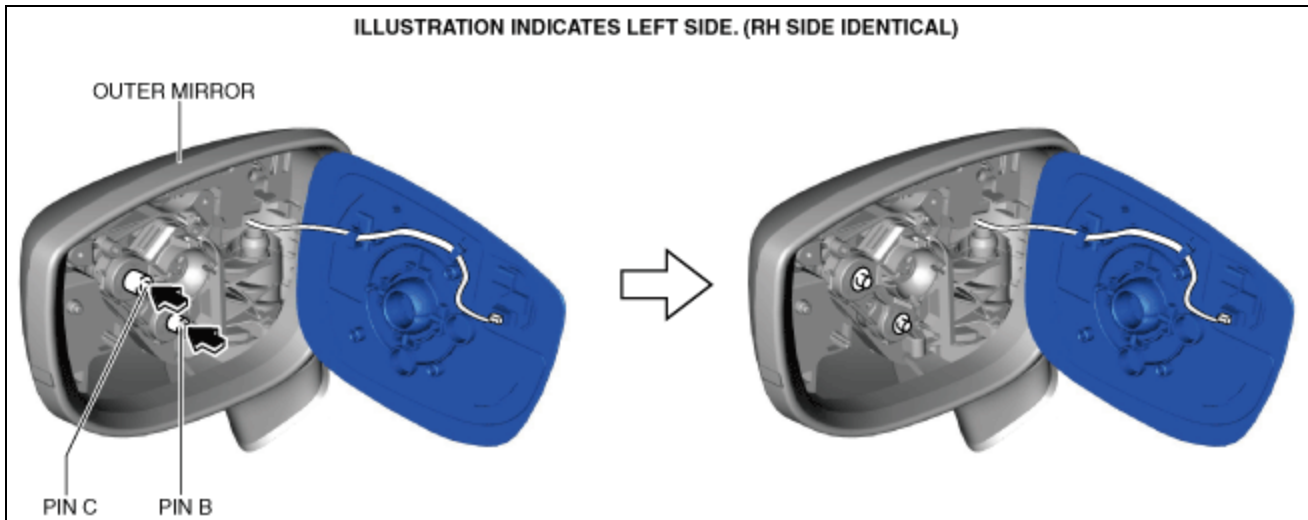

ac5uuw00006055

6. Align the outer mirror glass with the outer mirror in the direction of arrow (1) shown in the figure and install pin A while pressing in the directions of arrows (2).

**Caution**

- If the outer mirror moves when installing the outer mirror glass, the stay could be damaged. When installing the outer mirror glass, use both hands to press together the outer mirror glass and outer mirror.

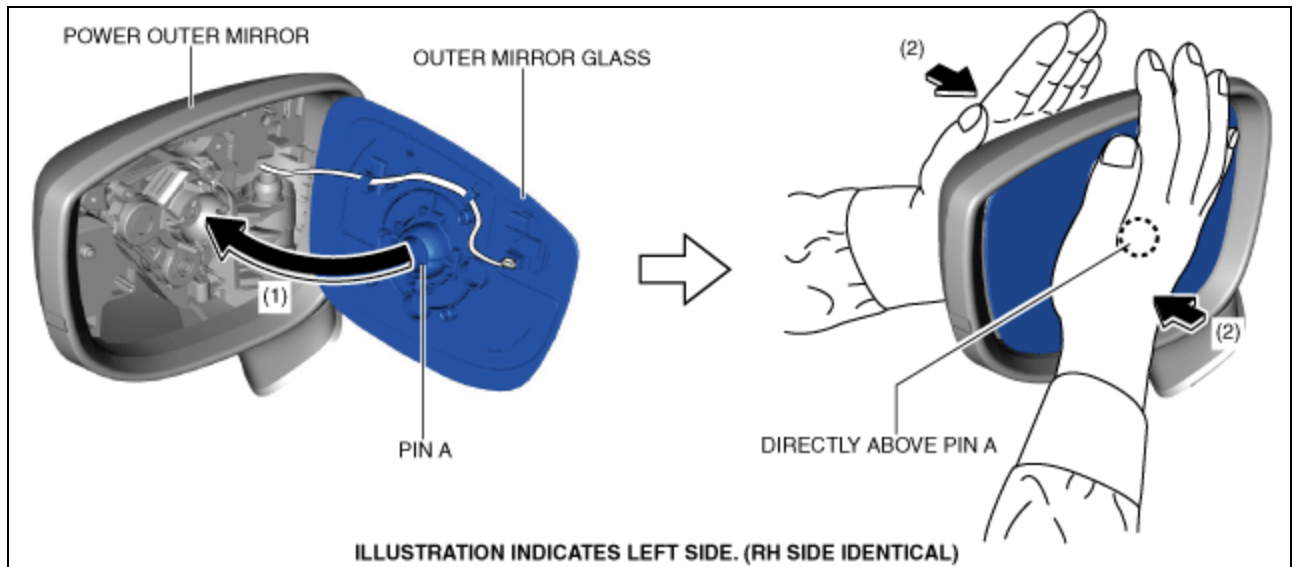

ac5uuw00006056

7. Install pins B and C in the same manner as Step 6.

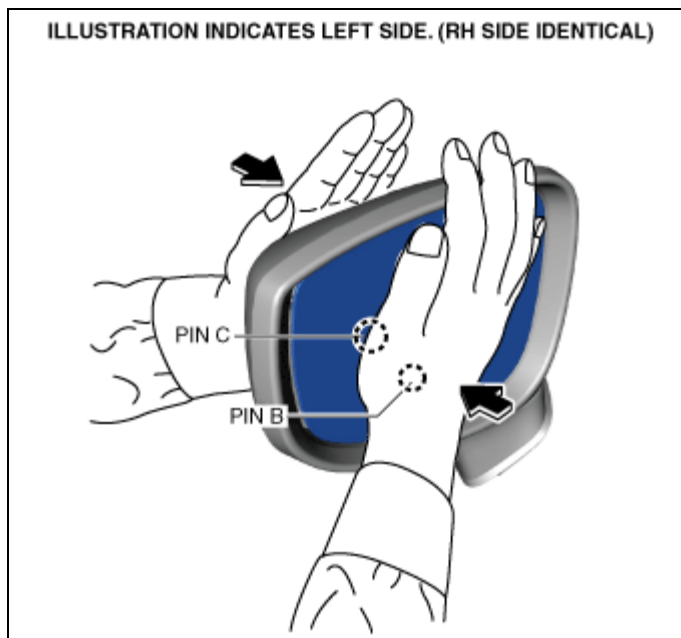

ac5uuw00006057

8. Connect the negative battery terminal. (See [NEGATIVE BATTERY TERMINAL DISCONNECTION/CONNECTION.](#))